

Poly CCX 500 Business Media Phone

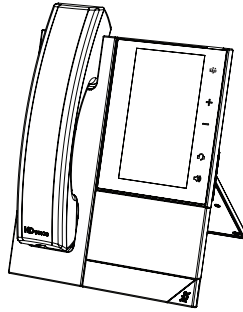

Package Contents

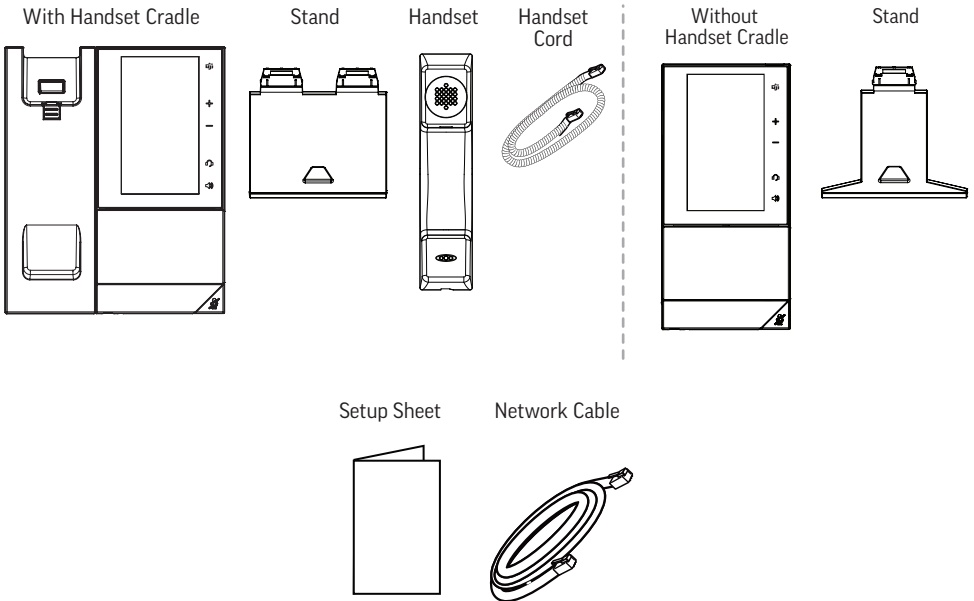

Optional Accessories



AC Power Adapter
(varies by region)

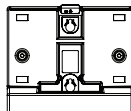

Wallmount

Features

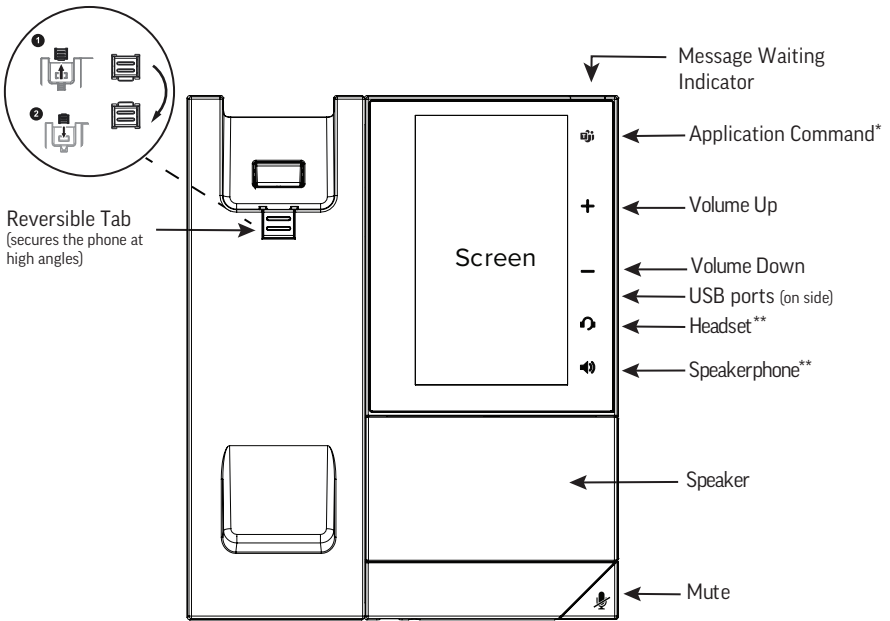

*Icon displays only when the phone is powered on and the service is available. Icon may vary.
** Icon displays when the phone is powered on.

Connect Desktop Stand

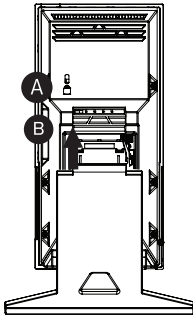

A

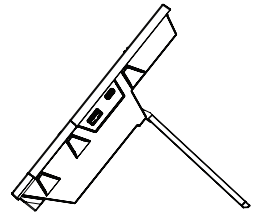

B

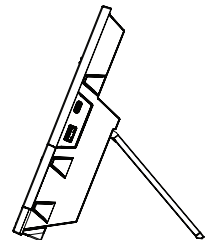
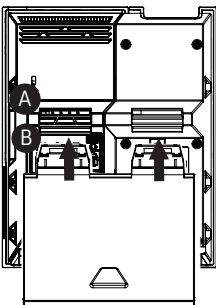

Connect Cables

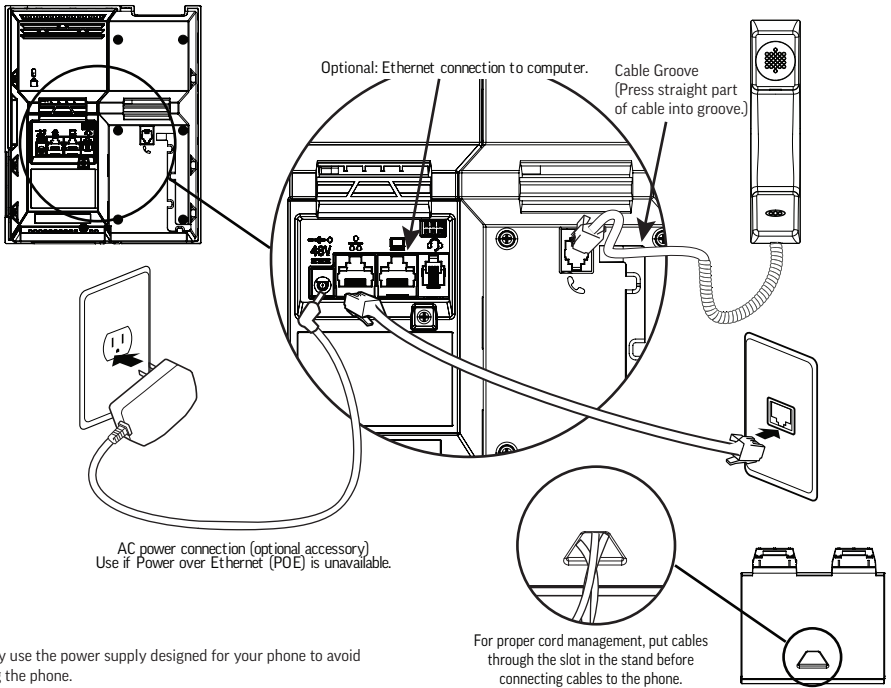

Connect Optional Headset

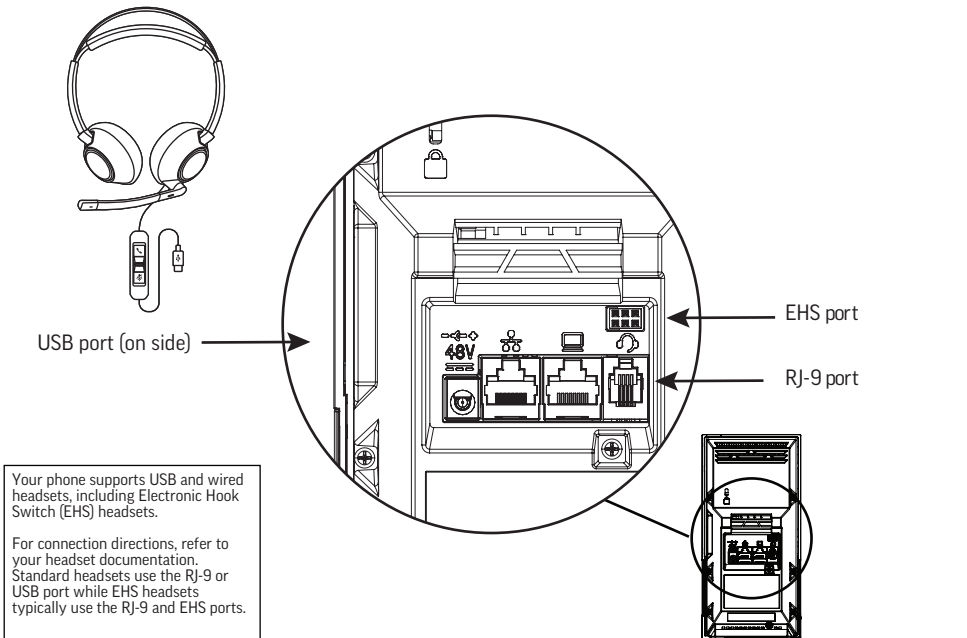



BY USING THIS PRODUCT, YOU ARE AGREEING TO THE TERMS OF THE END USER LICENSE AGREEMENT (EULA) AT:

<http://documents.polycom.com/indexes/licenses>. IF YOU DO NOT AGREE TO THE TERMS OF THE EULA, DO NOT USE THE PRODUCT, AND YOU MAY RETURN IT IN THE ORIGINAL PACKAGING TO THE SELLER FROM WHOM YOU PURCHASED THE PRODUCT.

Refer to the Limited Warranty section of the Product Warranty Guide found in Services at <http://support.polycom.com/>

Hereby, Poly declares that the radio equipment type CCX 500 is in compliance with Directive 2014/53/EU. The full text of the EU declaration of conformity is available at typeapproval@polycom.com.

Frequency Range	Maximum Transmit Power
2402-2480MHz	9.26 dBm

Polycom Documentation
www.polycom.com/support



ENERGY STAR®:



Backlight intensity and timeout can be adjusted in basic user settings menu. By default, after the phone is idle for 40 seconds, the backlight dims. The backlight automatically turns on with any phone activity.

© 2019 Plantronics, Inc. All rights reserved. Poly, the propeller design, and the Poly logo are trademarks of Plantronics, Inc. All other trademarks are the property of their respective owners.

Contact Information:

Contact your Authorized Reseller for Assistance.

www.poly.com

Plantronics, Inc. 345 Encinal Street Santa Cruz, California 95060

1725-49715-001B

